

ASSEMBLY INSTRUCTION

NO.	DESCRIPTION	Nm	Ft/Lb
<i>*Use a temporary thread retainer such as LocTite #609</i>			
1	Front M12 Locknut	115	85
2	Rear M12 Locknut	90	66
3	M8 Locknut	33	24
4	M8 Stainless Steel Button Head*	33	24

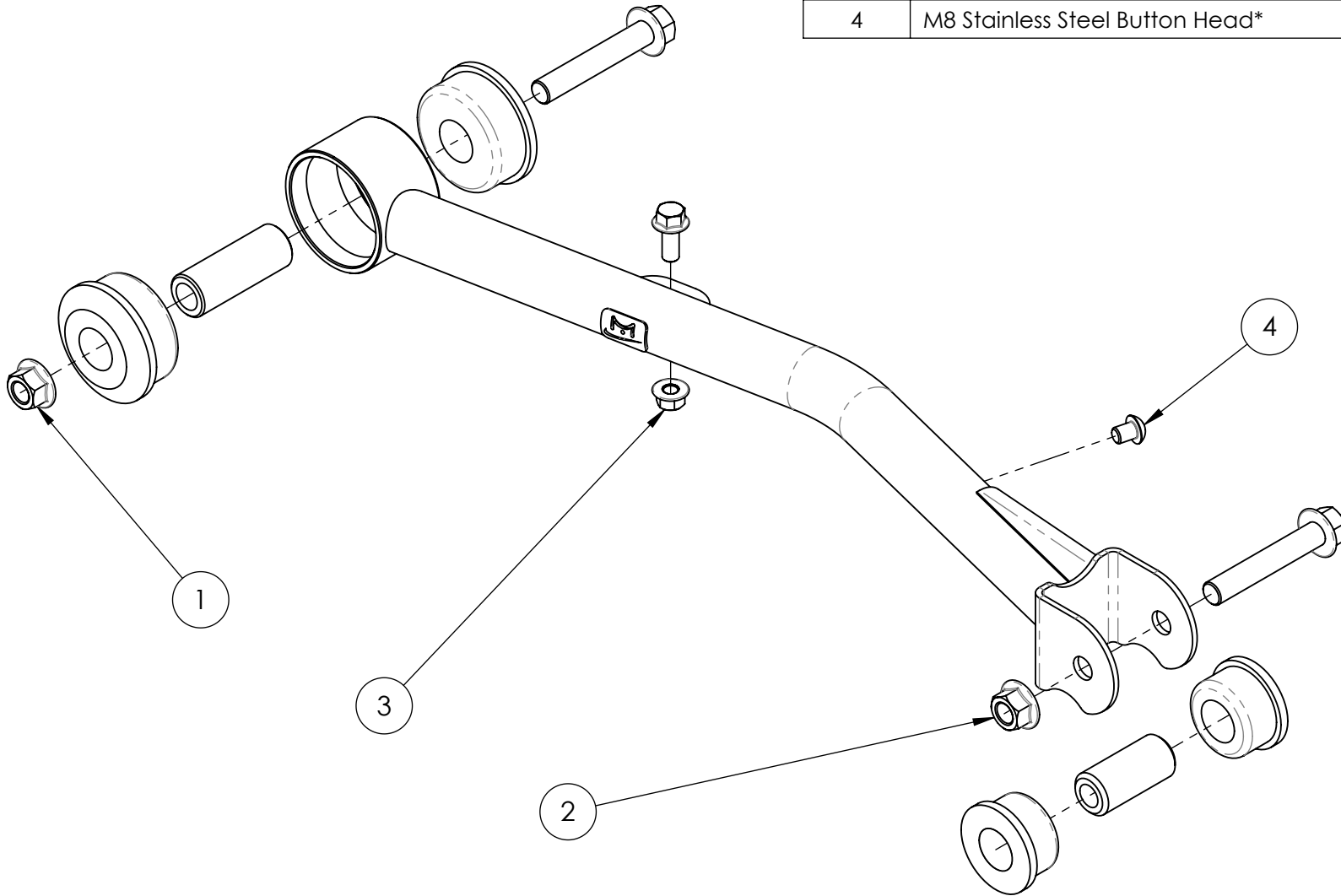

THE INFORMATION CONTAINED IN THIS DRAWING IS THE SOLE PROPERTY OF MSI (Moore-Sport INC.). ANY REPRODUCTION IN PART OR AS A WHOLE IS STRICTLY PROHIBITED.



Left Trailing Arm 1" Correction Bushing

CAR MODEL	Impreza GD	CONFIGURATION:	ASSEMBLY:	REV	2021-09-13
APPLICATION	Street / Motorsport	Install. Assy.	MSIsub02-28-012-LH	3	1333.86