

5

4

3

2

1

FOR CUSTOMER

E

E

D

D

C

C

B

B

FRONT OF VEHICLE

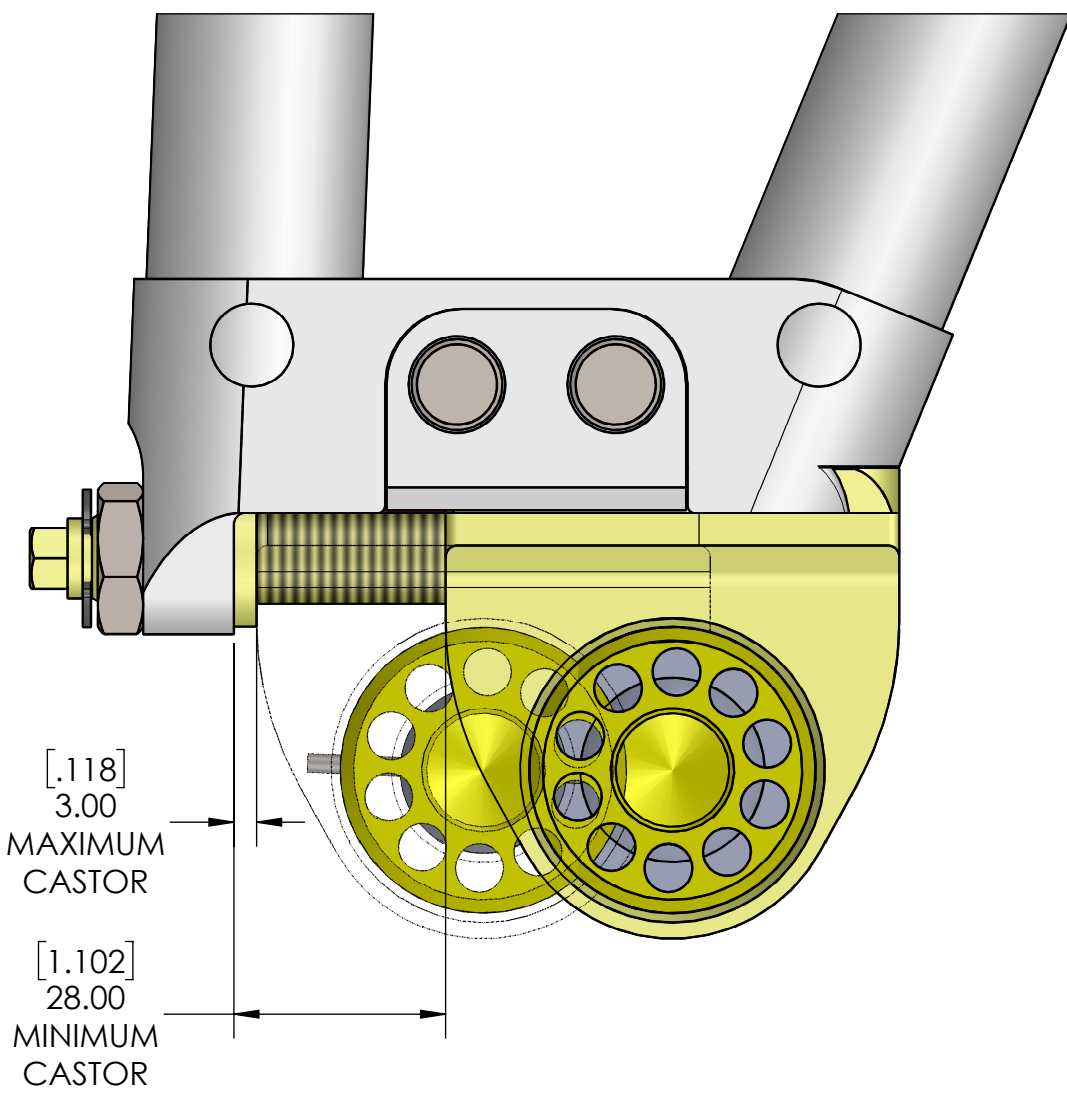

LH SIDE SHOWN
RH SIDE OPPOSITE

A

A

THE INFORMATION CONTAINED IN THIS DRAWING IS THE SOLE PROPERTY OF MooreSport Inc. ANY REPRODUCTION IN PART OR AS A WHOLE IS STRICTLY PROHIBITED.



High Caster front TCA w/pin

CAR MODEL	Impreza High Caster
APPLICATION	Street / Motorsport

ASSEMBLY:

MSIsub02-28-008

REV 1

2022-03-22
SHEET 4 OF 6

5

4

3

2

1

BOM FOR ASSEMBLY

NO.	DESCRIPTION	Nm	Ft/Lb
<i>*Use a temporary thread retainer such as LocTite #609</i>			
1	m12 Adjustment Jam Nut	40	30
2	m12 Cap Screw to Clamping Plate	85	63
3	m14 SS Castle Nut + max turn of 30deg	65	47

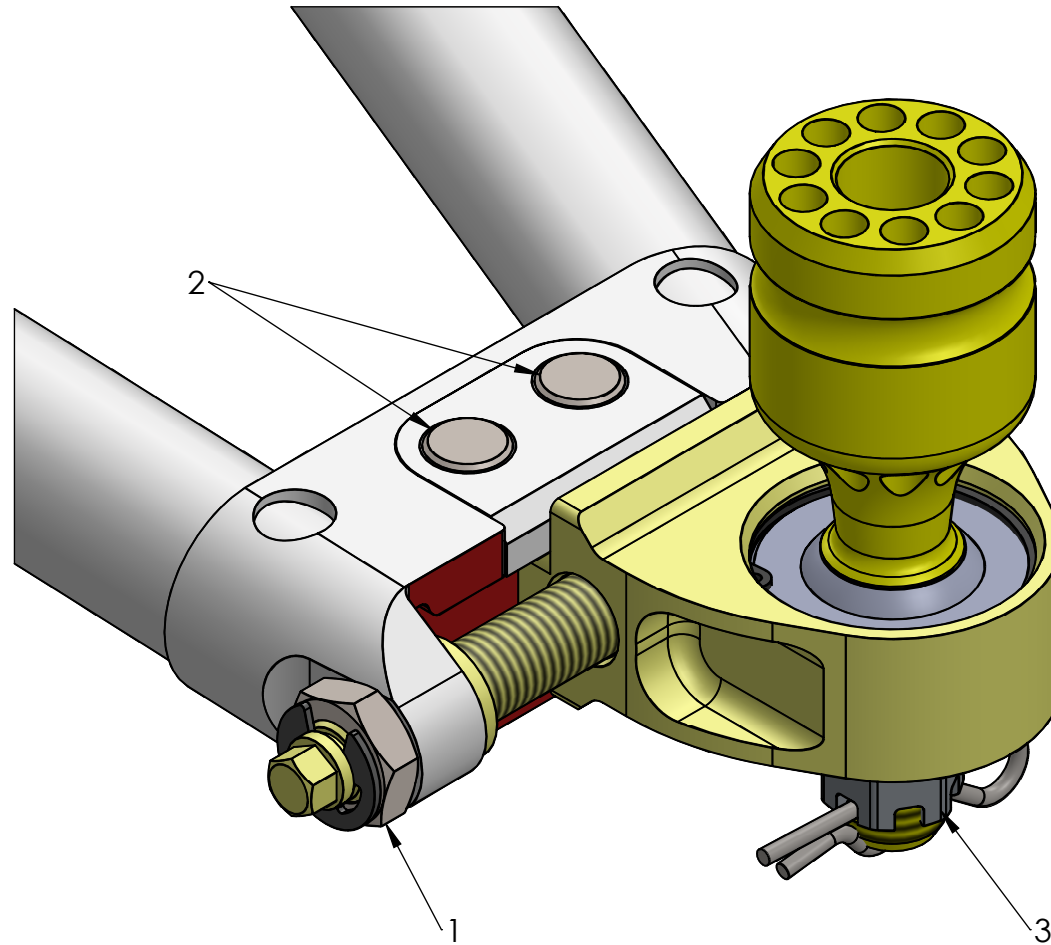

THE INFORMATION CONTAINED IN THIS DRAWING IS THE SOLE PROPERTY OF MSI (Moore-Sport INC). ANY REPRODUCTION IN PART OR AS A WHOLE IS STRICTLY PROHIBITED.



High Caster front TCA w/pin

CAR MODEL	Impreza High Caster	CONFIGURATION:	ASSEMBLY:	REV	2022-03-22
APPLICATION	Street / Motorsport	Default	MSIsub02-28-008	1	6722.951

BOM FOR ASSEMBLY

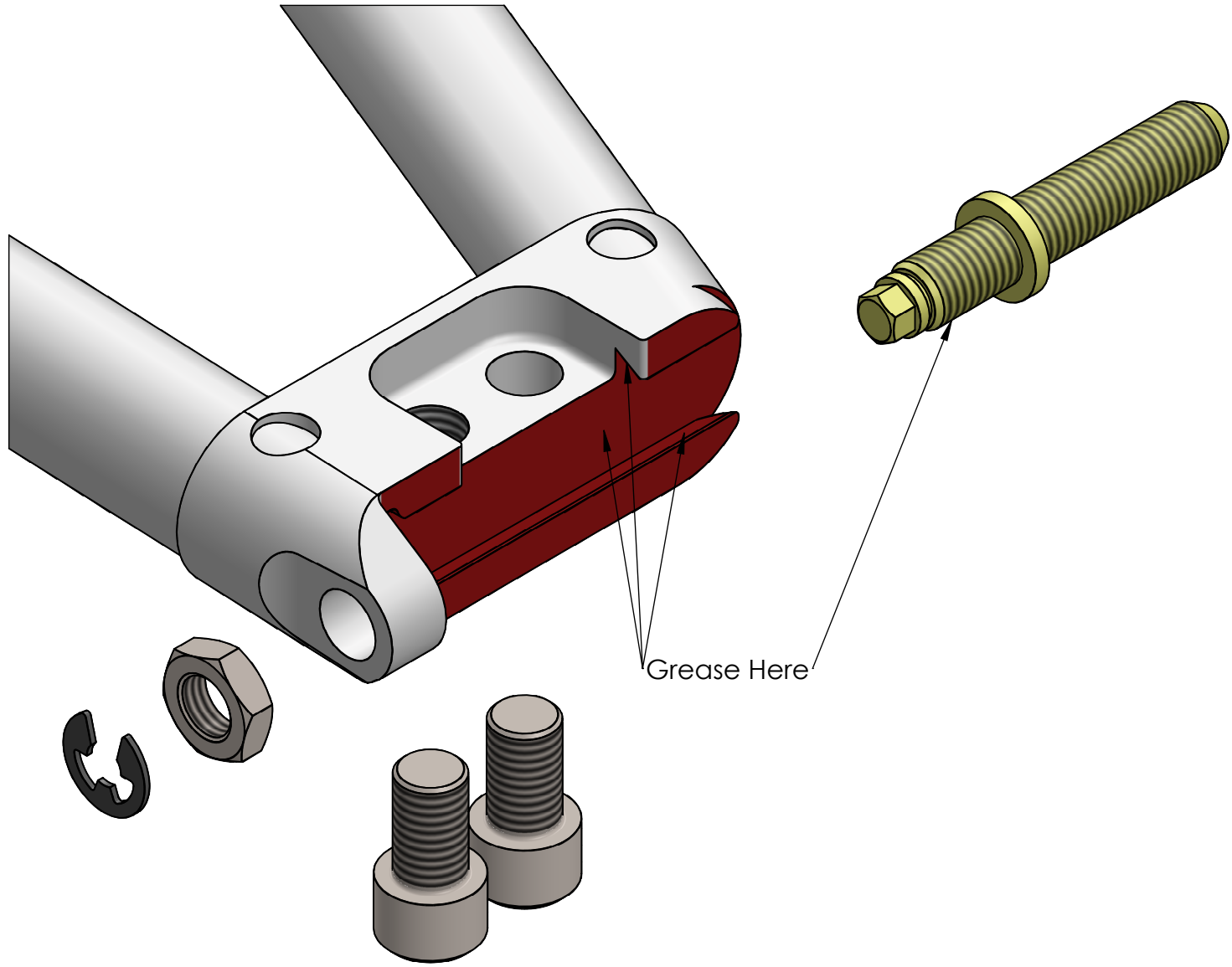

THE INFORMATION CONTAINED IN THIS DRAWING IS THE SOLE PROPERTY OF MSI (Moore-Sport INC). ANY REPRODUCTION IN PART OR AS A WHOLE IS STRICTLY PROHIBITED.



High Caster front TCA w/pin

CAR MODEL	Impreza High Caster	CONFIGURATION:	ASSEMBLY:	REV	2022-03-22
APPLICATION	Street / Motorsport	Default	MSIsub02-28-008	1	6722.951